



Okab

Pull-Down Faucet

Specifications

Practical cold-start function for energy saving	
Pull-down spout with 2 sprays	
Easy assembly due to central fixing nut	
Flexible metal connection hoses approx. 39.37"	
Connection type: High pressure	
Swivel range:	360°
Flow Rate:	1.75 gpm
Hole count:	1 to 3 (base plate available seperately)

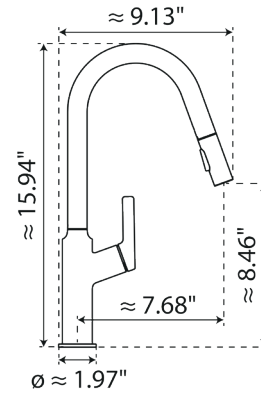

LEAD FREE
NSF/ANSI/CAN 61



C ®

Codes & Standards

- California Energy Commission (CEC)
- Department of Energy (DOE)
- ASME A112.18.1/CSA B125.1
- NSF/ANSI/CAN 61
- ADA Compliance
- NSF/ANSI 372
- MASS